

## **ROOF RACK THE VANCOUVER SPECIAL**

**1ST GENERATION PORSCHE CAYENNE  
1ST GENERATION VOLKSWAGEN TOUAREG**

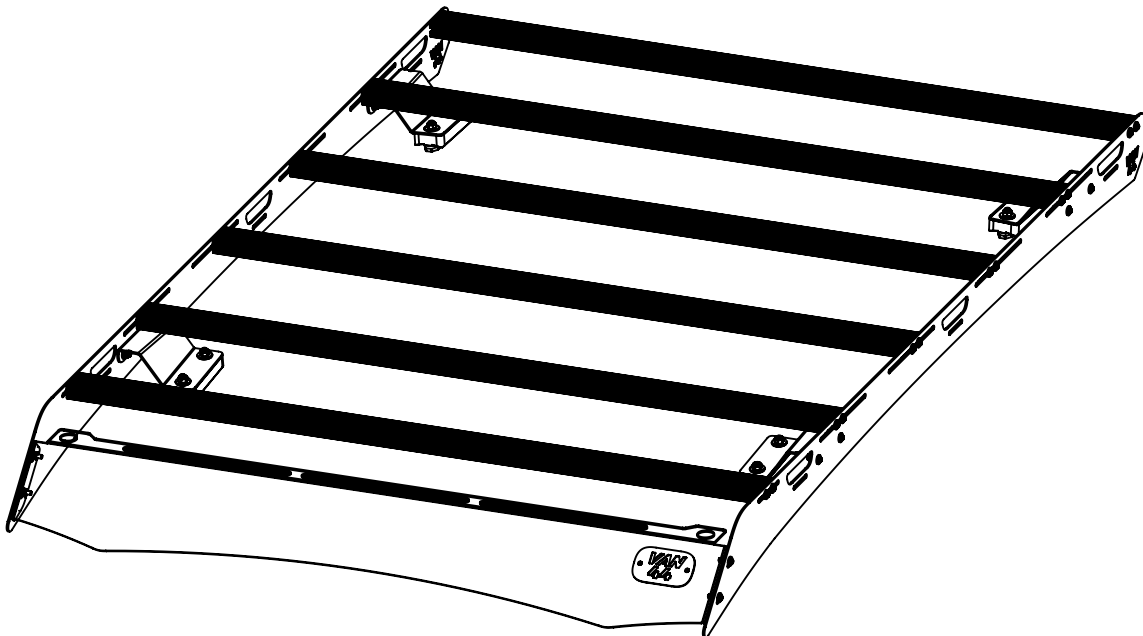

**INSTRUCTIONS**

# DISCLAIMER

By using this product, you agree to the following terms:

## Warranty Conditions

Any modification, tampering, or unauthorized repair of this product will void the warranty. If you decide to alter, "customize," or otherwise mess with it, you're fully responsible for the outcome.

## Liability Waiver

We are not responsible for any damage, injury, or chaos caused by improper use, unauthorized modifications, or failure to follow the provided instructions. If you're about to do something questionable, stop and contact us first. Seriously.

## Intended Use

This product is designed for **normal use in overlanding\***. Using it for anything else is entirely at your own risk. We can't protect you from bad ideas or reckless experimentation.

## Safety First

Use this product responsibly and with the proper tools and equipment. If you're unsure about anything, don't improvise—reach out to us first. Don't blame us if you hurt yourself doing something we explicitly told you not to do.

**Got questions? Don't wing it. Contact us before doing anything outside the scope of normal use.**

### \*Normal Use in Overlanding

This roof rack is designed to withstand the typical demands of overlanding and off-road adventures, including:

**Vehicle Travel on Off-Road Terrain:** Gravel roads, dirt trails, and uneven surfaces within the vehicle's capabilities.

**Carrying Gear:** Securing cargo, such as camping equipment, storage boxes, and other accessories, within the stated weight limits.

**Exposure to Outdoor Conditions:** Reasonable exposure to weather, such as rain, wind, and sunlight, under normal outdoor use.

### What's Not Included in Normal Use:

**Exceeding Weight Capacity:** Overloading the rack beyond its stated maximum weight limit, whether stationary or in motion.

**Impacts or Collisions:** Damage resulting from accidents, impacts with low-hanging objects, or other collisions.

**Improper Attachment:** Failure to securely fasten cargo, which may result in damage to the rack, vehicle, or items being transported.

**Extreme Conditions:** Submersion in water, exposure to corrosive materials, or prolonged use in extreme weather beyond the product's specifications.

**Unauthorized Modifications:** Drilling, cutting, or altering the rack in any way that affects its structural integrity.



**SUPPORT@VAN44.COM**

PARTS LIST

ITEM NO.	PART NUMBER	DESCRIPTION	QTY.
1	050101-0101	LH RAIL, PCAN1	1
2	050101-0102	RH RAIL, PCAN1	1
3	050101-0103	DEFLECTOR, PCAN1	1
4	050101-0104	TRACK PLATE, PCAN1	4
5	050101-0105	RL BRACKET, PCAN1	1
6	050101-0106	RR BRACKET, PCAN 1	1
7	050101-0107	FL BRACKET, PCAN 1	1
8	050101-0108	FR BRACKET, PCAN 1	1
9	050101-0109	TRACK SPACER	4
10	990000-1102	1200 CROSSBAR	6
11	88000-0602B	M6 X 15MM WASHER BO SS	44
12	88000-0201B	M6X 1X 20MM TX BO SS	36
13	88000-0301S	M6 X 1 NYLOCK 18-8	8
14	88000-0607S	M8 X 24MM WASHER 18-8	8
15	88000-0302S	M8 X 1.25 NYLOCK 18-8	8

TOOLS REQUIRED:

- 10MM WRENCH
- 13MM WRENCH
- T30 TORX BIT
- COPPER ANTI-SEIZE (SUPPLIED)
- MEASURING TAPE

DETAIL A  
SCALE 1 : 5

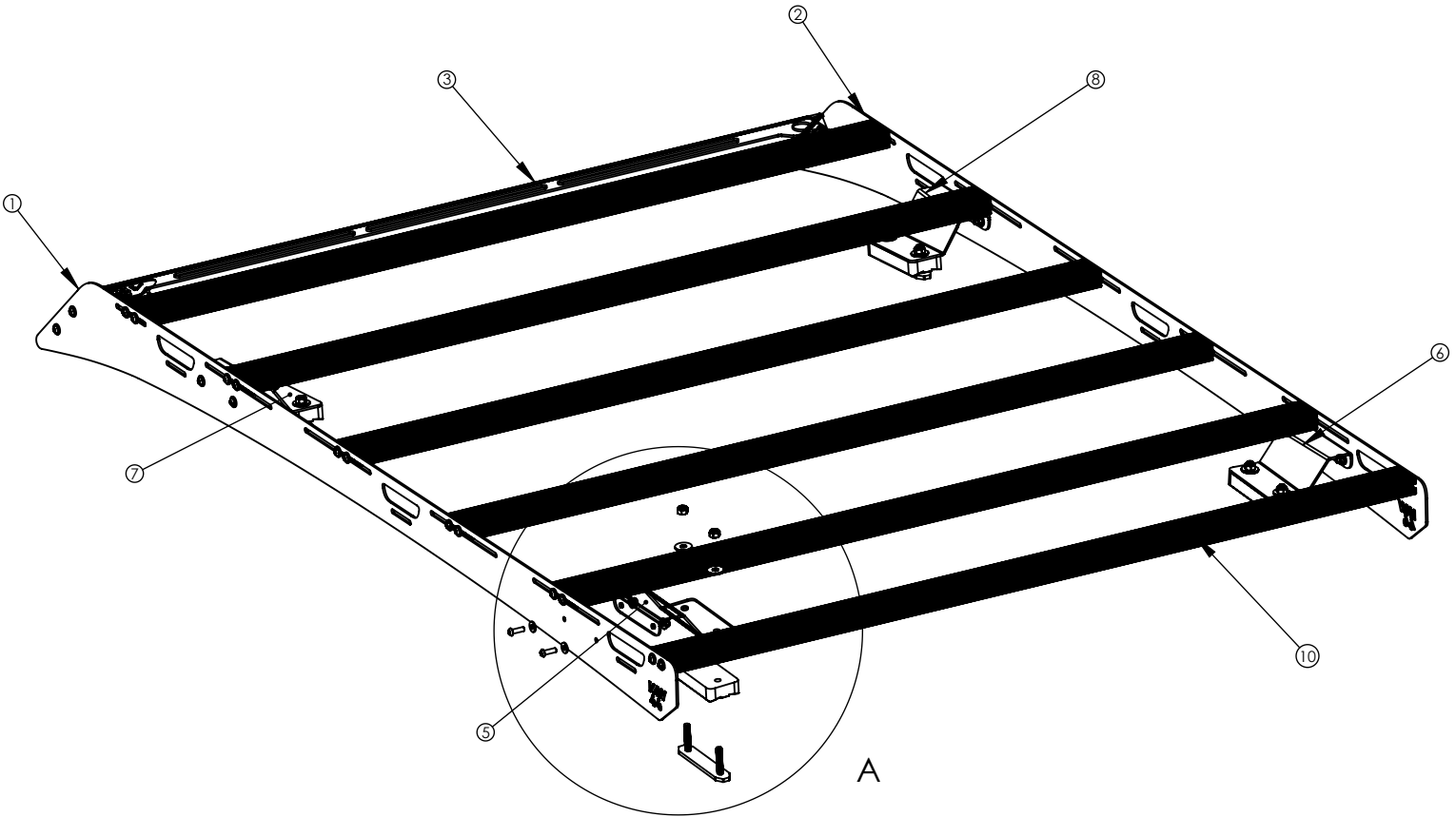
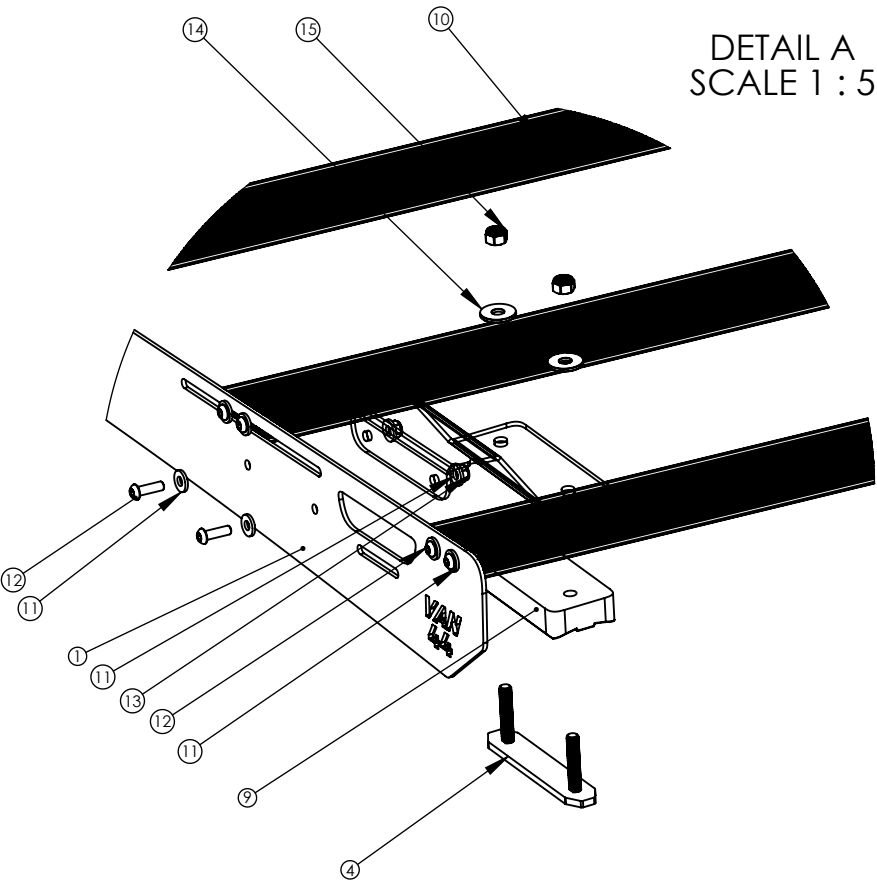

# STEP 1 - INSTALL THE RAIL BRACKETS

ITEM NO.	PART NUMBER	DESCRIPTION	QTY.
1	050101-0101	LH RAIL, PCAN1	1
2	050101-0102	RH RAIL, PCAN1	1
3	050101-0105	RL BRACKET, PCAN1	1
4	050101-0106	RR BRACKET, PCAN 1	1
5	050101-0107	FL BRACKET, PCAN 1	1
6	050101-0108	FR BRACKET, PCAN 1	1
7	88000-0602B	M6 X 15MM WASHER BO SS	16
8	88000-0201B	M6X 1X 20MM TX BO SS	8
9	88000-0301S	M6 X 1 NYLOCK 18-8	8

APPLY ANTI-SEIZE TO ALL BOLTS

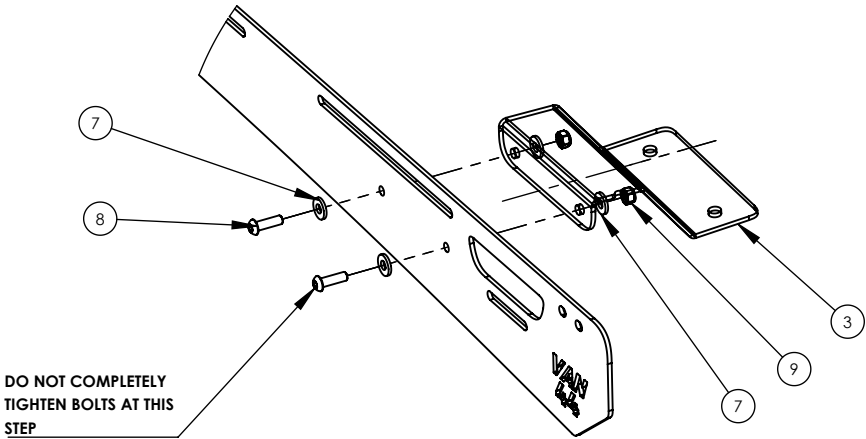

DETAIL C  
SCALE 1 : 5

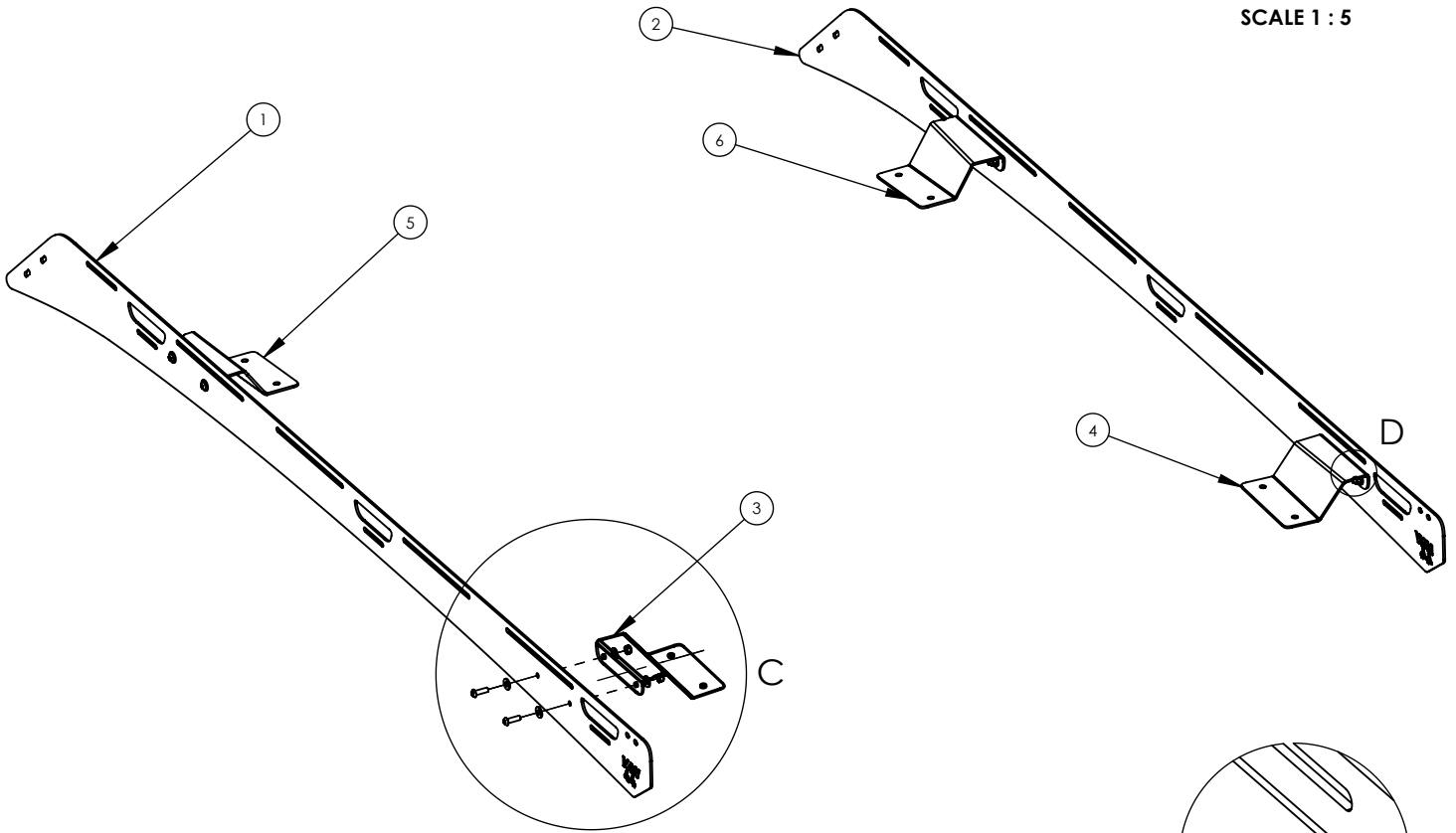

DETAIL D  
SCALE 1 : 2

NOTE: NOTCHES USED TO ORIENT PART. **ROUND** NOTCH FOR **REAR** BRACKETS. **TRIANGULAR** NOTCH FOR **FRONT** BRACKETS.

# STEP 2 - INSTALL THE TRACK PLATES

ITEM NO.	PART NUMBER	DESCRIPTION	QTY.
1	050101-0104	TRACK PLATE, PCAN1	4
2	050101-0109	TRACK SPACER	4
3	ROOF TRACK	OEM	2

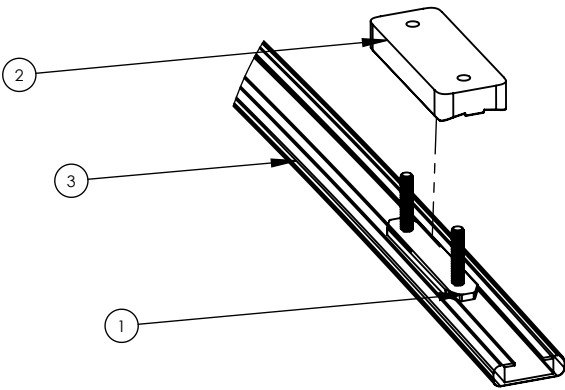

DETAIL G  
SCALE 1 : 5

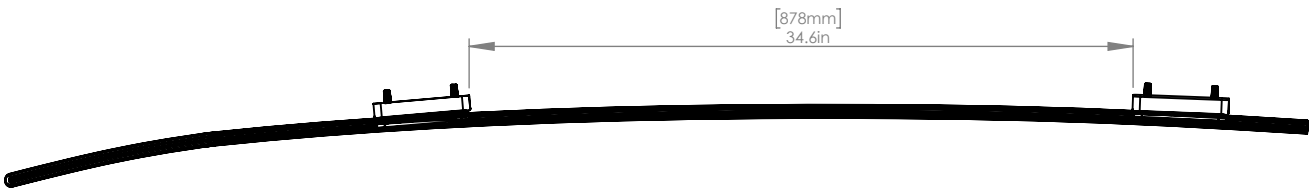
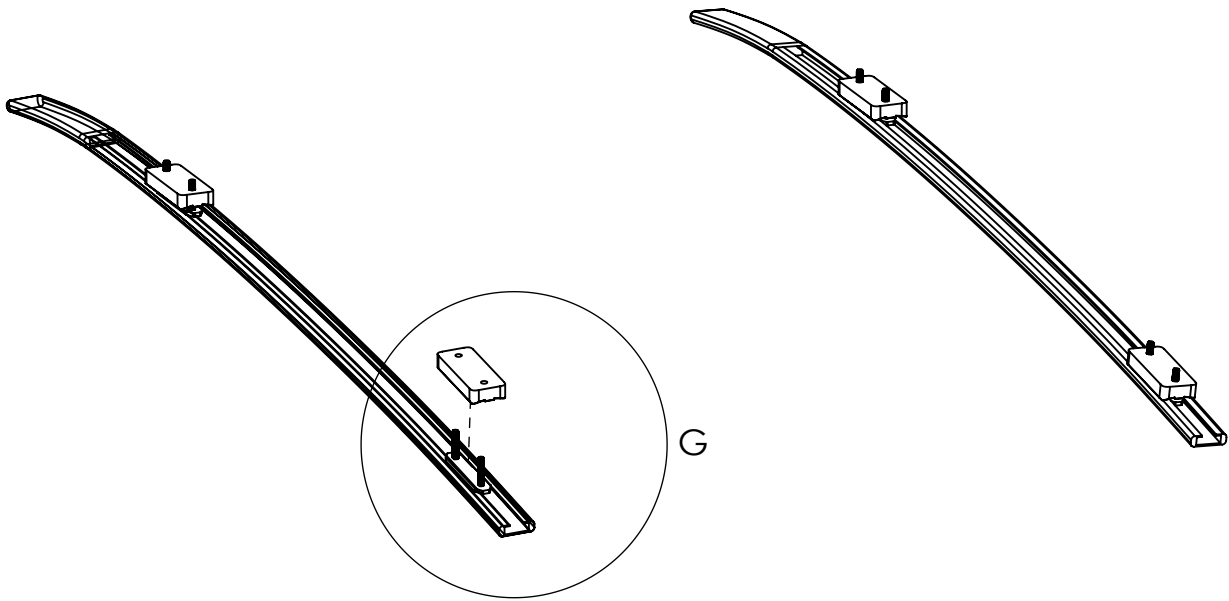

SHOWN: APPROXIMATE SPACING BETWEEN TRACK PLATES

# STEP 3 - INSTALLING RAILS, CROSSBARS

ITEM NO.	PART NUMBER	DESCRIPTION	QTY.
1	050101-0101	LH RAIL, PCAN1	1
2	050101-0102	RH RAIL, PCAN1	1
3	050101-0104	TRACK PLATE, PCAN1	4
9	990000-1102	1200 CROSSBAR	6
10	88000-0602B	M6 X 15MM WASHER BO SS	44
11	88000-0201B	M6X 1X 20MM TX BO SS	36
13	88000-0607S	M8 X 24MM WASHER 18-8	8
14	88000-0302S	M8 X 1.25 NYLOCK 18-8	8

## NOTE:

>> THE RAILS CAN BE INSTALLED INDIVIDUALLY, OR ALL TOGETHER WITH THE CROSSBARS ASSEMBLED.

>> IT'S IMPORTANT THAT BOLTS (11) HAVE NOT YET BEEN TIGHTEND AS THEY NEED TO BE LOOSE TO GIVE CLEARANCE TO THE CROSSBARS ABOVE THEM

**APPLY ANTI-SEIZE TO ALL BOLTS**

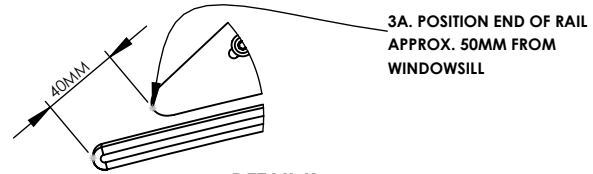

DETAIL K  
SCALE 1 : 5

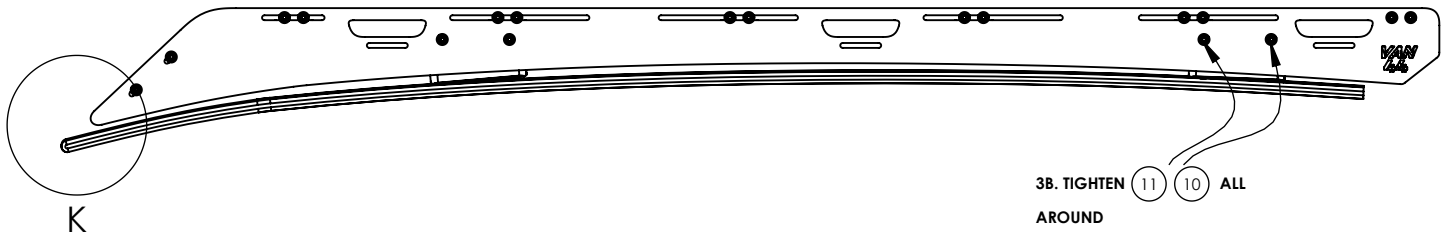

3C. TIGHTEN (13) (14) , ALL AROUND

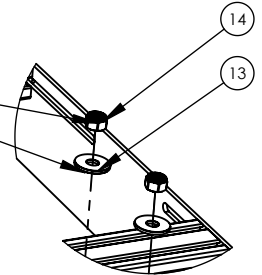

DETAIL I  
SCALE 1 : 5

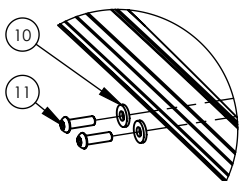
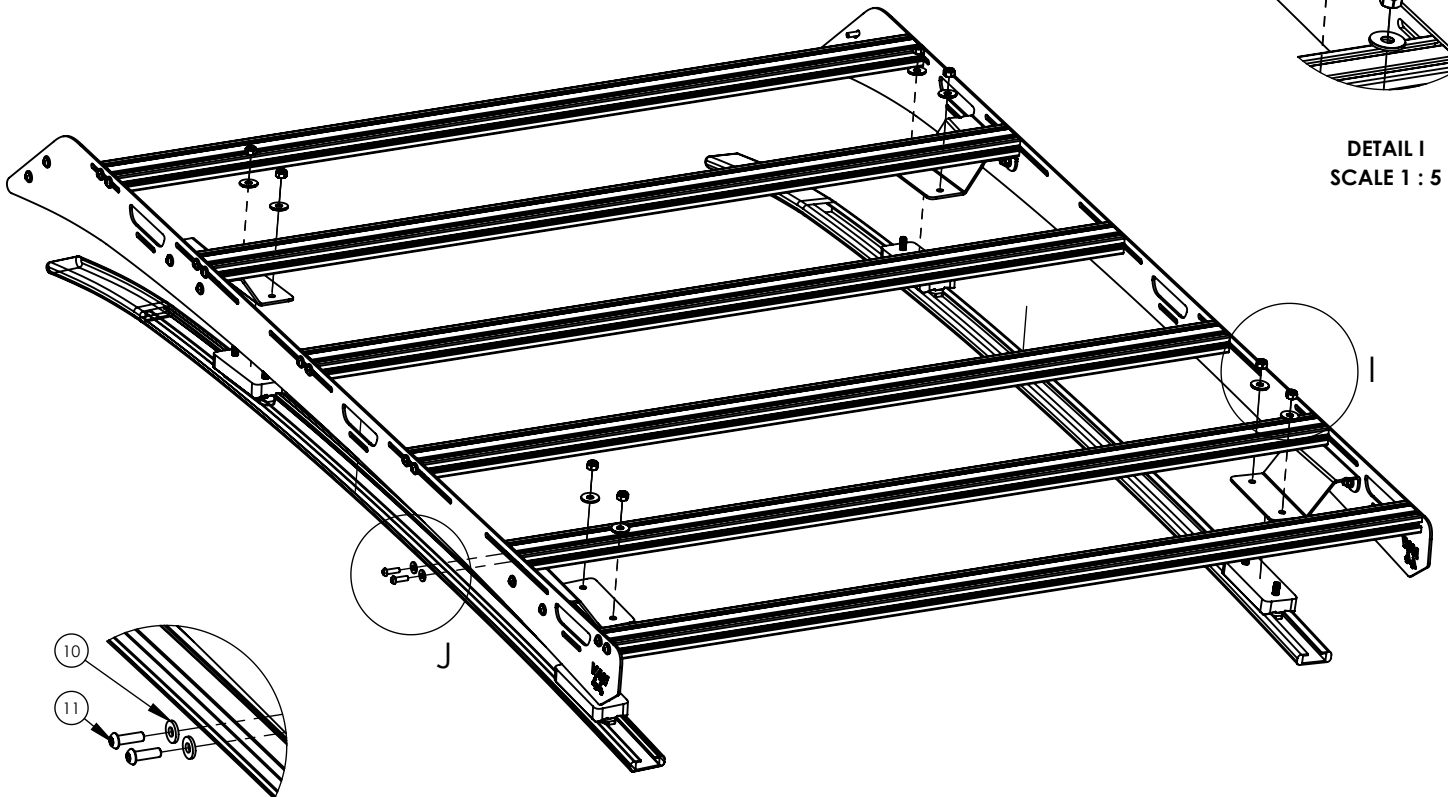

DETAIL J  
SCALE 1 : 5  
(3B)

# STEP 4 - INSTALLING DEFLECTOR, FINISHING

ITEM NO.	PART NUMBER	DESCRIPTION	QTY.
3	050101-0103	DEFLECTOR, PCAN1	1
11	88000-0602B	M6 X 15MM WASHER BO SS	44
12	88000-0201B	M6X 1X 20MM TX BO SS	36

**NOTES:**  
>> PROTECTIVE RUBBER TRIM IS SUPPLIED, BUT ADDITIONAL OPTIONS TO PROTECT THE PAINT UNDERNEATH CAN BE APPLIED SUCH AS A 3M CLEAR VINYL STRIP

**APPLY ANTI-SEIZE TO ALL BOLTS**

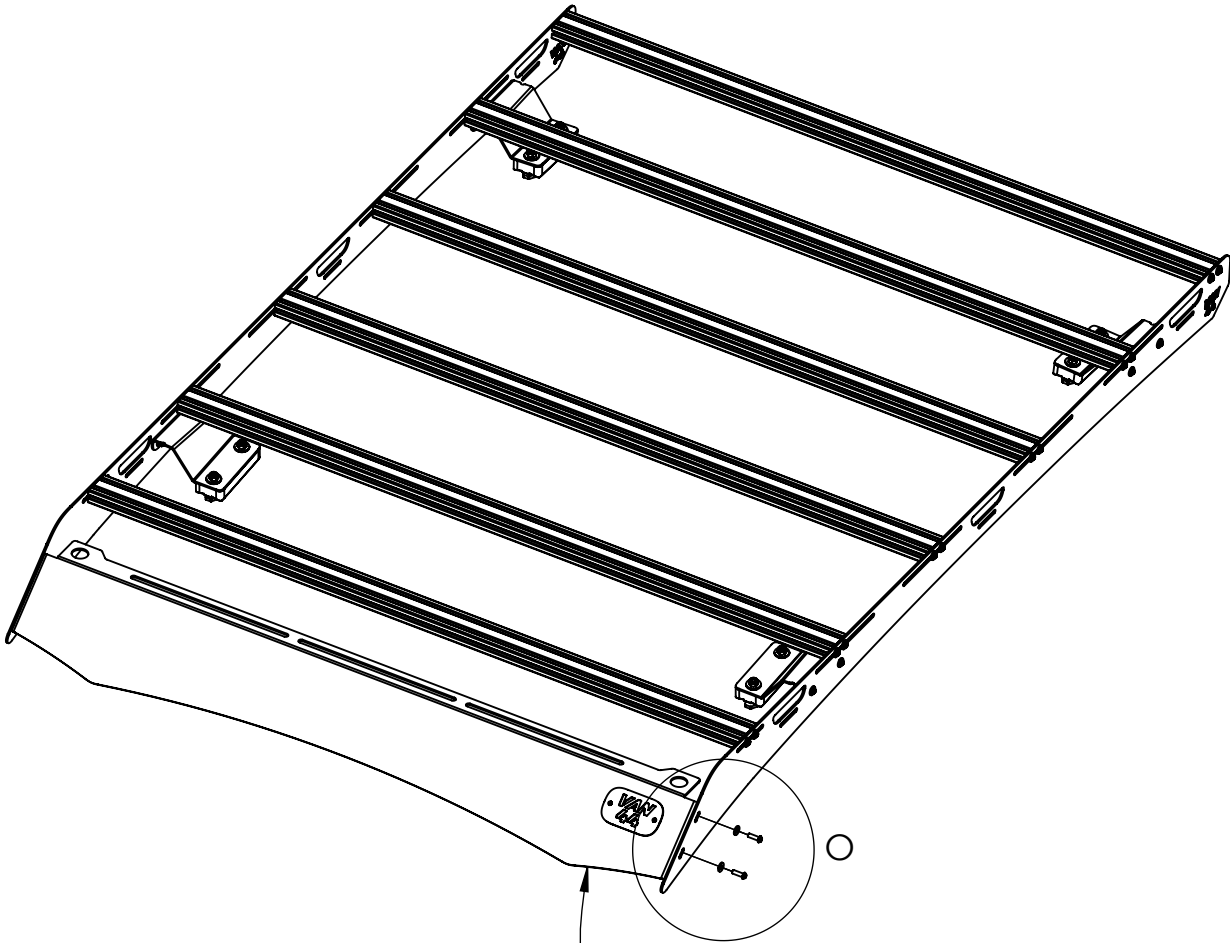

4A. SLIDE THE DEFLECTOR ALL THE WAY TO THE ROOF UNTIL THE GAP IS CLOSED BETWEEN THE RUBBER TRIM AND ROOF LINE. ENSURE PARALLELISM TO THE CROSSBARS

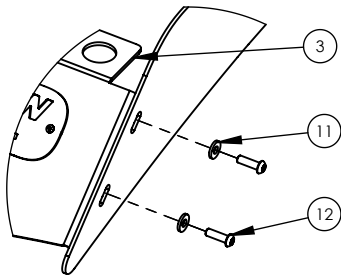

DETAIL O  
SCALE 1 : 6

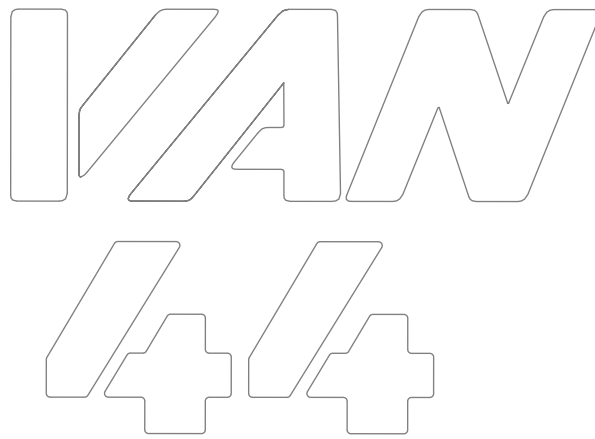

**VAN44.COM**  
**SUPPORT@VAN44.COM**  
**INSTAGRAM: @VAN44\_OFFROAD**